

Removal of Reel Handle

Remove the reel handle by tightening the star drag as much as possible. With you left hand, pull the star drag in towards the reel body. While holding the star drag in, turn the reel handle backwards until it comes off.

To put the handle back on, hold the star drag in as before while screwing the handle on. Release the star drag. With the drag still tightened, put your thumb on the spool and check to see if the handle is firmly seated. If not, pull the star drag in again and turn the handle firmly forward. Release the star drag and check again. You should feel the handle lock into place.

Care and Lubrication

Your new Rick Clunn Signature Series reel is designed to provide years of dependable service. But like any other precision machine, periodic cleaning and maintenance is required for continued peak performance.

Reels made today require both a lightweight oil and grease to be used. Oil and grease should be used sparingly, too much can have a negative impact on reel performance. There are lightweight oils and greases made specifically for fishing reels.

Oil should be applied to all bearings, the worm gear, and the crank shaft. Grease should be applied to the drive gears, crank gears, the pinion gear, and all bushings.

We do not recommend using any multipurpose oil. Many of these oils have properties that will attract dirt and dust to the internal parts. This may cause excessive wear and reduce the life of the reel.

After each trip the reel should be checked for dirt or sand. If it has been exposed to saltwater, the spool should be removed and the entire reel rinsed with water. Dry with a soft cloth and lubricate the reel as described above.

For professional cleaning and maintenance send your reels postage prepaid to:

Outdoor World Rod & Reel Repair

2300 E. Turner, Suite M

Springfield, MO 65803

Phone (417) 873-5274 Fax (417) 873-5280

One-Year Limited Warranty

Bass Pro Shops will repair or replace (at our discretion) any Rick Clunn Signature Series baitcast reel which proves to be defective in workmanship or materials within one year from the date of the original date of purchase. You must save your dated sales receipt for warranty validation. This warranty gives you specific legal rights, and you may have other rights which vary from state-to-state.

For reels purchased through our catalogs or Bass Pro Shops online:

For reel replacement only: Return your reel **postage prepaid** to the Return Center address listed on your receipt along with your dated sales receipt.

For reel repair only: Return your reel **postage prepaid with a copy of your dated sales receipt** as proof of purchase and warranty validation to the Outdoor World Rod & Reel address listed above.

For reels purchased through Outdoor World/Sportsman's Warehouse retail locations:

For reel replacement only: Return your reel (**postage prepaid if sending by mail**) to the store from which it was purchased along with your dated sales receipt.

For reel repairs only: Return your reel **postage prepaid with a copy of your dated sales receipt** as proof of purchase and warranty validation to the Outdoor World Rod & Reel address listed above.

This warranty does not cover lost parts, malfunctions or damage due to abuse, accidents, normal wear, or cleaning and re-lubrication required due to the owners' failure to provide reasonable and necessary maintenance.

Repairs needed to your reel due to abnormal use, modification, or reels past the one-year warranty period are available for a reasonable charge, providing the reel is returned **postage prepaid**, from Outdoor World Rod & Reel repair.

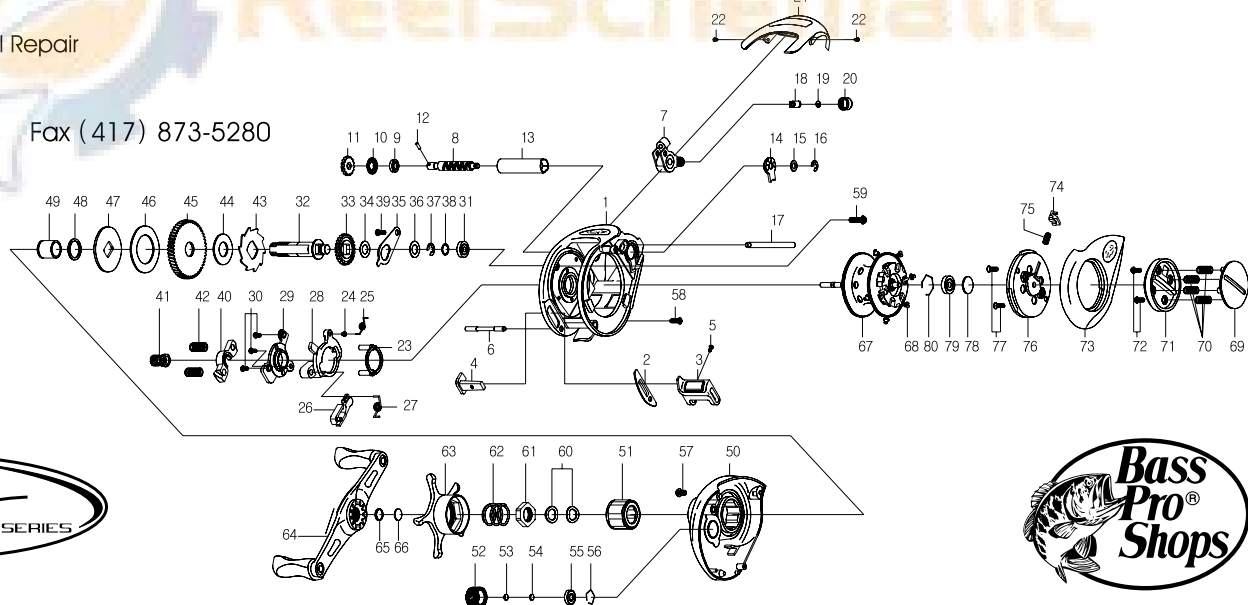

THE ORDER OF THE PART NUMBER IS BASED ON THAT OF THE REEL ASSEMBLY

NO	PART NAME	NO	PART NAME	NO	PART NAME	NO	PART NAME	NO	PART NAME	NO	PART NAME
1	FRAME ASSEMBLY(INCL. N/PLATE)	16	E-RING	31	BALL BEARING	46	DRAG WASHER (B)	61	DRAG NUT	76	SPOOL COVER
2	CLUTCH BAR PLATE	17	PILLAR	32	CRANK SHAFT	47	DRAG WASHER (D)	62	STAR DRAG SPRING	77	SPOOL COVER SCREW(*2)
3	CLUTCH BAR ASSEMBLY	18	LINE GUIDE PAWL	33	IDLER(L)	48	SLEEVE WASHER(OPTIONAL)	63	STAR DRAG ASSEMBLY	78	SPOOL SPACER(A)
4	CLUTCH LINK	19	SPACER(OPTIONAL)	34	IDLER(L) WASHER (A)(OPTIONAL)	49	SLEEVE	64	HANDLE ASSEMBLY(INCL. 4BB)	79	BALL BEARING
5	CLUTCH BAR SCREW	20	PAWL CAP	35	BEARING PLATE	50	RIGHT SIDE COVER ASSEMBLY	65	CUSHION WASHER	80	BEARING RETAINER
6	CLUTCH BAR SUPPORT	21	FRONT COVER	36	IDLER(L) WASHER (B)	51	ONE WAY CLUTCH	66	HANDLE SPACER		
7	LINE GUIDE ASSEMBLY	22	FRONT COVER SCREW (*2)	37	E-RING	52	CAST CONTROL CAP ASSEMBLY	67	SPOOL ASSEMBLY(INCL. 1BB)		
8	WORM SHAFT	23	YOKE HOLDER	38	CRANK SHAFT SPACER(OPTIONAL)	53	TENSION WASHER	68	BRAKE COLLAR(WHITE)(*6)		
9	BALL BEARING	24	CLUTCH SPRING BUSHING	39	BEARING PLATE SCREW	54	SPOOL SPACER (B)	69	LEVER PLATE		
10	WORM SHAFT BUSHING	25	CLUTCH SPRING	40	PINION YOKE	55	BALL BEARING	70	LEVER PLATE SPRING(*4)		
11	IDLER(S)	26	RETURN PAWL	41	PINION GEAR	56	BEARING RETAINER	71	LOCK LEVER		
12	WORM SHAFT PIN	27	RETURN PAWL SPRING	42	PINION YOKE SPRING(*2)	57	RIGHT SIDE COVER SCREW (A)	72	LOCK LEVER SCREW(*2)		
13	LINE GUIDE PIPE	28	CLUTCH CAM	43	RATCHET	58	RIGHT SIDE COVER SCREW (B)	73	LEFT SIDE COVER ASSEMBLY		
14	WORM SHAFT BUSHING (B)	29	CAM PLATE	44	RATCHET WASHER	59	RIGHT SIDE COVER SCREW (C)	74	LOCK PIN		
15	WORM SHAFT WASHER(OPTIONAL)	30	CAM PLATE SCREW (*3)	45	DRIVE GEAR	60	DRAG SPRING WASHER(*2)	75	LOCK PIN SPRING		